

Nitro® Glide Knee Walker

Andador de rodilla con
deslizamiento Nitro®

Déambulateur Reponse-
genou Nitro® Glide

item #s:

791BL

791RD

drive®



Y Sung Handelsvertretung
Duesselthaler St. 24, 40211
Duesseldorf, Nordrhein-Westfalen, Germany

www.drivemedical.com

parts list



WEIGHT CAPACITY: 350 LBS (158 KG)

- | | |
|-----------------------|---------------------------------|
| 1. Handgrip | 7. Brake |
| 2. Handbrake | 8. Tiller Locking Tab |
| 3. Handle Height Knob | 9. Basket |
| 4. Knee Pad | 10. Basket Receptacle |
| 5. Knee Post | 11. Front Axle Adjustment Knobs |
| 6. Knee Post Lock Tab | |

Nitro™ Glide Knee Walker includes:

- | | | |
|-----------|-------------|---------------------------|
| 1. Basket | 2. Knee Pad | 3. Operating Instructions |
|-----------|-------------|---------------------------|

operating instructions

The Nitro™ Glide Knee Walker is a mobility device that provides strength and comfort to anyone who may have an injury below the knee. It allows an even distribution of body weight by supporting half of the weight on the device and the other half on the non-injured leg. The device has a cushioned platform to support both the injured leg and ankle ensuring that no weight will be placed on the lower leg.

The device is designed for easy steering and stopping. Brakes are also featured on this device for controlled movement and safety.

- Placement of injured leg on pad should be centered side to side and positioned forward to cover the full length of pad.
- With injured leg on pad, stand as straight as possible (adjust height of the Knee Walker as necessary).
- With injured foot pointing down, the propulsion leg should be maintained as close as possible to the pad.
- While on your toes, start out with small steps with propulsion leg. Concentrate on keeping that leg next to the pad. With practice, you should be able to move forward without deviating to the opposite side.

assembly instructions

1. Remove contents from carton.
2. Straighten tiller to the upright position. Slide locking mechanism to the side to allow tiller to reach full upright position (Fig 1). Release locking mechanism to lock tiller in position (Fig 2.)

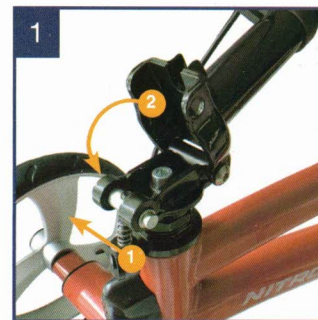

3. Slide locking tab into groove on tiller (Fig 3) and depress locking tab to secure tiller in place (Fig 4). Note: If tiller feels loose, lift the locking tab and rotate counterclockwise to tighten. Depress locking tab to secure tiller in place.

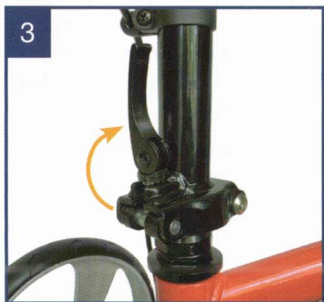

4. Insert knee pad post into receptacle on frame (Fig 5). Secure pad in place by inserting locking pin into hole (Fig 6).

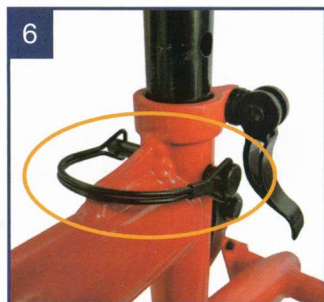
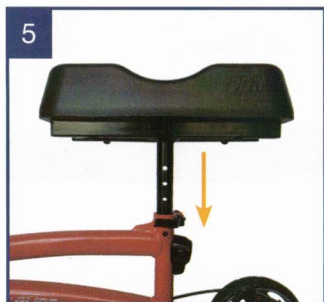

5. Lock pad in position using locking tab (Fig 7).

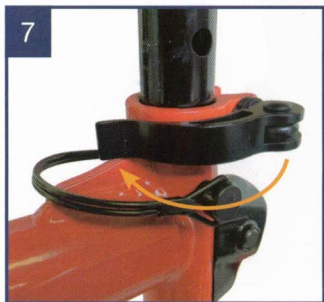

6. Attach basket by sliding basket receptacles down over hooks on the front of the tiller (Fig 8).



using the handbrakes

Do not use the Knee Walker if brake system is not working properly.

- The Knee Walker's brake is similar to a bicycle and includes a locking feature.
- To use the brake, simply pull the lever towards the handlebar with your fingertips. Pulling the left or right brake lever will apply the brake to both wheels. Always brake slowly and steady.
- To lock the brake, pull brake lever towards handlebar and push down spring loaded push button (Fig 9). When done correctly, push button will remain down and brake lever will be locked in place.
- To release brake, simply pull lever towards the handlebar (Fig 10). Push pin will pop up automatically.

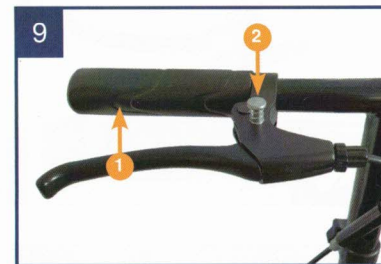

adjusting the hand brake

You may need to adjust the hand brake system from time to time as it wears with normal use. For adjustment of the brake cable tension, brake adjusters located near the handbrakes can be turned counterclockwise (adjusting the cable adjuster away from brake lever housing) to tighten brake cable, or clockwise (adjusting the cable adjuster towards brake lever housing) to loosen brake cable.

To tighten the cable, screw both the lock nut and adjuster counterclockwise until desired adjustment is reached. To secure, screw lock nut clockwise and ensure it is tight against the brake lever housing (Fig 11). To loosen cable, loosen lock nut, turn cable adjuster clockwise until the adjustment is satisfactory, and tighten the lock nut only against the brake lever housing

If further adjustment is required, apply a similar method of adjustment at the lower cable adjuster, located near the brake mechanism. Use same principle for adjusting the cable adjuster away from the lever to tighten brake cable, and towards the lever to loosen cable - please note, this adjuster does not feature a lock nut.

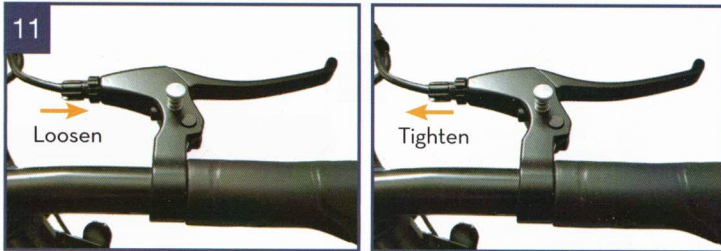

adjusting the handle height

To adjust handle height, loosen the handle height adjustment knob on tiller by turning it counterclockwise until it can be removed (Fig 12). Adjust hand grips to the desired height and reinstall the adjustment knob by turning it clockwise to tighten.

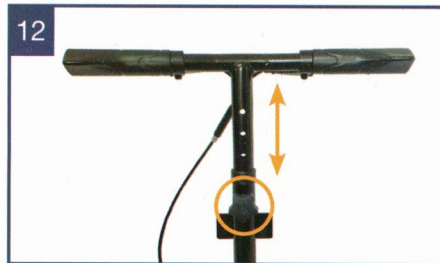

adjusting the knee pad height

To adjust knee pad height, loosen locking tab under pad (shown in step 5 of assembly) and remove locking pin (shown in step 4 of assembly). Adjust pad to the desired height then reinstall locking pin and secure it in place with the locking tab (as shown in step 4 of assembly). Next tighten the locking tab (as shown in step 5 of assembly) to lock pad in place.

adjusting front axle

The knee walker adjusts to three different width settings (16", 18", 20") to cater to user preferences and environment. The knee walker will arrive at the narrowest width setting and the 3 linear markings on the front axles indicate the different width positions. The line closest to the wheel represents 16" and width increases as the axels are pulled further away from the frame. To adjust width of the front axle, turn knee walker on its side. Turn the front axle adjustment knob counterclockwise until it can be removed (Fig 13). Adjust to the desired position and reinstall knob by turning it clockwise until it is tightened. Repeat with the other side using the linear markings on the front axle to ensure each side is adjusted equally.

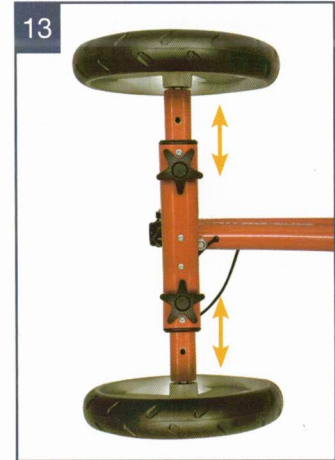

to fold tiller

To fold tiller down, release the tiller locking tab (as shown in step 3 of assembly) and slide assembly to the side (as shown in step 2 of assembly) until tiller is disengaged. Fold the tiller down until it rests under the knee pad and release locking mechanism.



safety instructions and cautions

The following safety instructions and warnings are provided to educate the user on how to safely operate a knee walker. Knee Walkers are mobility devices designed to provide increased mobility during recovery from foot/ankle/lower leg surgery or injury. This is a walking aid, not a recreational device. For the user's safety, it is important to always follow these safety instructions.

- Engage the lock and practice bending, reaching and transfers on and off the Knee Walker. DO NOT use the Knee Walker by yourself until you have been properly trained, once you have practiced with someone and feel confident you can maneuver by yourself.
- The use of the Knee Walker is individual to the person. You should develop your own methods for use based on your personal level of function and ability.
- NEVER attempt a maneuver that has not been practiced.
- Be aware of your surroundings when operating the Knee Walker. Look for hazards and avoid them.
- Contact your provider if any parts are loose or show excessive wear.
- Do not operate on loose gravel or uneven surfaces.
- Do not travel over large cracks or fissures.
- Stop and move forward slowly when encountering cracks or separations in walkway surfaces.
- Do not operate in excess of 3 miles per hour (slow-to-moderate walking speed).
- Do not turn unless one foot is on the ground.
- Do not turn at speeds over 1 mph (very slow walking speed).
- Do not operate on inclines above 15 degrees (slight incline).
- Do not travel over drops or barriers such as curbs or parking stops.
- This is a medical device, not a toy. Do not allow children or adults to use this for recreational purposes.
- Always check the fasteners on the tiller, wheels, brakes, and pad for tightness before use.
- Ensure braking system is working properly before use.
- Adjust steering mechanism to the correct height.
- Do not sit, stand, or lean on steering mechanism.
- Steering mechanism is not weight bearing.

cleaning

Clean regularly by hand with a damp cloth and mild detergent only.

maintenance

Drive DeVilbiss Healthcare recommends periodic visual inspection of this product by the user to ensure that all parts and hardware are secure and all components are in good working order and not worn, torn, frayed, or loose. There should be no obstructions or impediments to normal and safe operation. If any part or mechanism appears to be unsafe or compromised, do not use the product. If you experience any problems or issues, please contact the provider that sold you the product or visit www.drivemedical.com/help for more information.

lifetime limited warranty

Your Drive® brand product is warranted to be free of defects in materials and workmanship for the lifetime of the original consumer purchaser.

This device was built to exacting standards and carefully inspected prior to shipment. This Lifetime Limited Warranty is an expression of our confidence in the materials and workmanship of our products and our assurance to the consumer of years of dependable service.

This warranty does not cover device failure due to owner misuse or negligence or normal wear and tear. The warranty does not extend to non-durable components such as rubber accessories, casters, and grips, which are subject to normal wear and need periodic replacement.

If you have a question about your Drive® device or this warranty, please contact an authorized Drive® dealer.

drive[®]

© 2022 Medical Depot, Inc. All rights reserved.
Drive and Nitro are registered trademarks of Medical Depot, Inc.
Port Washington N.Y. 11050 USA Made in China